

NOTE: BREAK ALL CORNERS WITH 0.015" (.38 MM) RADIUS UNLESS OTHERWISE SPECIFIED. STANDARD TOLERANCES TO APPLY UNLESS OTHERWISE SPECIFIED.

CUSTOMER PART No.	<b>CAN ART STD.</b>	DIE No. <b>EH05394</b>
DESCRIPTION	1" x 1" x 0.120" THK. SQ. TUBE	PROPOSAL No. <b>H-2027</b>

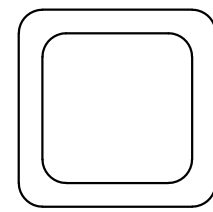
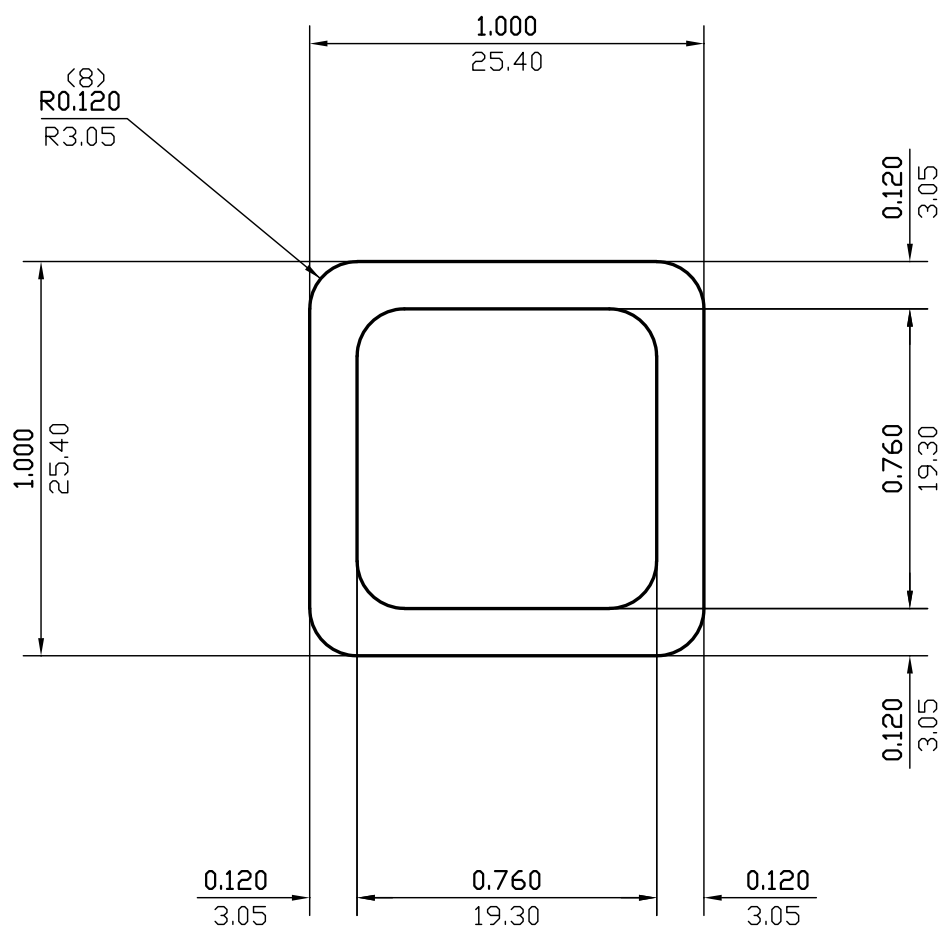

ACTUAL SIZE

WALL THICKNESS 0.120 (3.05) EXCEPT AS SHOWN

DATE	REV	DESCRIPTION	BY		
03/13/23	2	REMOVED ALLOY	JASON		
08/06/99	1	REDRAWN	P.M.		
EST. AREA	0.422	IN. <sup>2</sup>	EST. AREA	273	MM. <sup>2</sup>
EST. WT.	0.498	LBS/FT.	EST. WT.	0.742	KG/M.
EST. PER.	6.628	IN.	EST. PER.	168.4	MM.
OUT PER.	3.794	IN.	OUT PER.	96.4	MM.
C.C.D.	1.315	IN.	C.C.D.	33	MM.
FACTOR	13	FINISH	M/F	ALLOY & TEMP.	
CKD BY		SCALE	2:1	DWN BY	J.D.
				DATE	05/13/91

# CAN ART

ALUMINUM EXTRUSION INC.

85 PARKSHORE DRIVE  
BRAMPTON, ONT L6T 5M1  
TEL. NO. (905) 791-1464  
FAX NO. (905) 791-9151  
E-MAIL: canart@canart.com

THIS DRAWING IS NOT NECESSARILY A COPY OF YOUR ORIGINAL. PLEASE APPROVE DIMENSIONS AND TOLERANCES INDICATED. CAN ART ASSUMES NO RESPONSIBILITY EITHER TECHNICAL OR LEGAL FOR HAVING THIS SHAPE MADE. THE CUSTOMER AGREES TO FULLY PROTECT CAN ART ALUMINUM FROM CLAIMS OF OTHERS RESULTING FROM THIS SHAPE.

SIGNED: \_\_\_\_\_ DATE: \_\_\_\_\_